



West Manheim Township, York County, PA

2412 Baltimore Pike Hanover, PA 17331

Ph: (717)632-0320 Fax: (717)632-2499 www.westmanheimtwp.com

Application for Pool/Hot Tub

Location of Improvement –

Property Owner Name: _____ Contact Number: _____

Address: _____

Map & Parcel: _____ Zoning District: _____ (R,F,C-I, BC,RR,SR)

Contractor Information – (if applicable)

Name: _____ Contact Number: _____

Address: _____

Contractors PA Home Improvement License #: _____

Pool Information –

Pool Type: In-ground / Above Ground (Hard Side) / Above Ground (Soft Side) / Hot Tub

Installation of the following: Deck Yes No / Fence Yes No / Patio Yes No

Length: _____ Width: _____ Depth: _____

Stormwater management may be required for concrete decking/patio.

Engineered stormwater plans for areas over 1000 sq ft.

Required at Submission –

_____ Drawing of pool and related projects (location, size, shape, distance to property lines, residence, easements)

_____ Drawing showing construction specifications

_____ Submission of Contractor's Workers Compensation Certificate (if applicable)

_____ Inground Pool requires submission of application fee of \$165.00

_____ All Above Ground Pools and Hot Tubs require submission of application fee of \$90.00

Estimated Project Cost of Improvement: \$ _____

****Please remove the last 2 pages of this packet. Pages contain information & specifications for construction ****

Workers' Compensation Insurance Coverage Information

(Attach to building application)

A. The applicant is: _____

A contractor within the meaning of the Pennsylvania Worker's Compensation Law

YES

NO

If the answer is "yes," complete Sections B and C below as appropriate.

B. Insurance Information

Name of Applicant: _____

Federal or State Employer Identification No.: _____

Applicant is qualified self-insurer for workers' compensation.

Certificate attached

Name of Workers' Compensation Insurer: _____

Workers' Compensation Insurance Policy No.: _____

Certificate attached

Policy Expiration Date: _____

C. Exemption

Complete Section C if the applicant is a contractor claiming exemption from providing workers' compensation insurance.

The undersigned swears or affirms that he/she is not required to provide workers' compensation insurance under the provisions of Pennsylvania's Workers' Compensation Law for one of the following reasons, as indicated:

Contractor with no employees. Contractor prohibited by law from employing any individual to perform work pursuant to this building permit unless contractor provides proof of insurance to the township.

Religious exemption under the Workers' Compensation Law.

Subscribed and sworn to before me this

_____ day of _____ 20____

(Signature of Notary Public)

My commission expires: _____

(seal)

Signature of Applicant: _____

Address: _____

County of: _____

Municipality of: _____

CERTIFICATION

I hereby certify that I am the owner of record of the named property, or that the proposed work is authorized by the owner of record and that I have been authorized by the owner to make this application as his/her authorized agent and understand and assume responsibility for the establishment of the official property lines for required setbacks prior to start of construction and agree to conform to all applicable laws of this jurisdiction. I further certify that this information given is true and correct to the best of my knowledge.

Applicant Signature: _____ Date: _____

Municipal/Inspector Use

Zoning Code: _____ Building Code: _____

Stormwater required: Yes No

Floodplain: Yes No

Building Plan Review: Approved: _____ Not App'd: _____ Date: _____ Code Official: _____
 Codes Administrator: Approved: _____ Not App'd: _____ Date: _____ Code Official: _____
 Electric Plan Review: Approved: _____ Not App'd: _____ Date: _____ Code Official: _____
 Third Party Inspector: Approved: _____ Not App'd: _____ Date: _____ Code Official: _____
 Utilities Plan Review: Approved: _____ Not App'd: _____ Date: _____ Code Official: _____
 Zoning Plan Review: Approved: _____ Not App'd: _____ Date: _____ Code Official: _____

Special Notes: _____

Third Party Inspections Fees:		Township Fees	
Plan Review:	\$	Building Application:	\$
Building:	\$	PA State Fee:	\$4.50
Electrical:	\$	Electric App & Inspection	\$
Other:	\$	Plan Review:	\$
Other:	\$	Building Inspections:	\$
Other:	\$	Stormwater:	\$
Other:	\$	Zoning Permit:	\$50.00
Total MDIA Fees:	\$	Total Twp Fees:	\$

Private In and Above Ground Pools

General Information:

- A pool is any structure that contains water over 24 inches deep.
 - Includes: In-ground, aboveground, soft-side, and on-ground pools; hot tubs; spas; and fixed in-place wading pool

Location and Setbacks:

- The waters edge shall not be located **closer than 20 feet** from the **rear property line** and **10 feet** to the **side property lines**.
- The swimming pool, walks/paved areas, and accessory structures shall be located **no less than 5 feet** from the **side & rear property lines**.
- Swimming pools shall **not encroach** on **front yard** area.

Enclosure Requirements:

- **Fence or Wall:**
 - Pool surface area of **150 sq ft or more & a minimum depth of 2 ft** shall be **completely enclosed** by a **barrier/fence**.
 - Fence or walls should be no less than **4 feet** in **height** measured from lower horizontal frame.
 - **Horizontal** pieces spaced **less than 45 inches** apart force **vertical** pieces of fence **not to exceed 1.75 inches**.
 - **Openings** in the fence or barrier shall **not allow** passage of a **4 inch diameter** sphere.
 - **1-1/4 inches square chain link** mesh is acceptable.
 - Fences are **not required** if pool is **over 4 feet** in **height** with a **retractable ladder**.
 - **Fence or barrier** shall be **erected prior** to **filling** the pool with water.
- **Gates:**
 - **Self-closing, self-latching** device is required for keeping the gate or doors securely **closed at all times**.
 - **Latches** should be located at **least 54 inches** from the **bottom** of the gate or **3 inches** below the **top** of the gate on the **pool side** of the fence with a **1/2" maximum opening** within **18 inches** of the **latch**. (See reverse for diagram)
- **Alarm Sounding Doors:**
 - **Alarms** are **required** where the **dwelling serves** as part of pool **barrier** with a **direct access** to pool.
 - **Direct access door** must be **equipped** with **alarm** producing **warning of entrance**.
 - Alarm shall **sound continuously** for a minimum of **30 seconds**.

Electrical Requirements:

- **Flexible Cords:**
 - **Fixed or stationary pools 20 amps or less** are allowed to be connected to flexible cords with a max. length of 3 feet.
 - **Storable pools** the flexible cord shall **not exceed 20 feet** in length.
- **Cords** supplying pool equipment shall have a **copper grounding conductor not smaller than 12 AWG** and shall be provided with **grounding-type attachment plug**.
- **Receptacles providing power** for **water-pump motors or other loads** directly related to circulation and sanitation system are permitted to be **located between 5 ft and 10ft** from **inside walls of pool**.
 - **Receptacles** shall be **single and locking** and **grounding type** and shall be **protected by ground-fault circuit interrupters**.
- At least **one 125-volt 15 or 20 ampere** receptacle supplied by a general-purpose branch circuit is required.
 - Receptacle shall be located a **min. of 10 feet** and **not more than 20 feet** from the inside pool walls.
 - Receptacle shall be located **not more than 6 feet 6 inches** above **floor** of pool area.
- **Underground Wiring:**
 - **Wiring** shall **not** be installed within the area extending **5 feet horizontally** from inside walls of pools **except** where wiring is installed to **supply** pool equipment.
 - Where **inside 5 feet** wiring method shall be **rigid metal conduit, intermediate metal conduit, or a nonmetallic raceway system**.

Minimum Burial Depth:

Wiring method	Minimum Burial Depth (inches)
Rigid Metal conduit	6
Intermediate Metal Conduit	6
Nonmetallic raceways (listed for direct burial without concrete encasement)	18
Other approved raceways (direct burial)	18

Fence Depictions

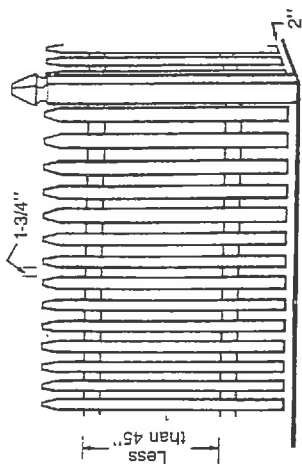

PARA. 4: IF HORIZONTAL MEMBERS ARE LESS THAN 45° APART, VERTICAL SPACING SHALL NOT EXCEED 1-3/4"

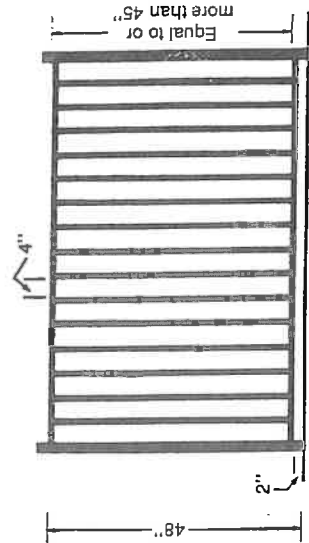

PARA. 5: IF HORIZONTAL MEMBERS ARE EQUAL TO OR MORE THAN 45° APART, VERTICAL SPACING SHALL NOT EXCEED 4"

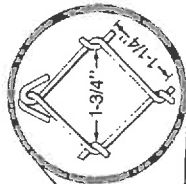

PARA. 6: 1-1/4" SQUARE CHAIN LINK MESH.

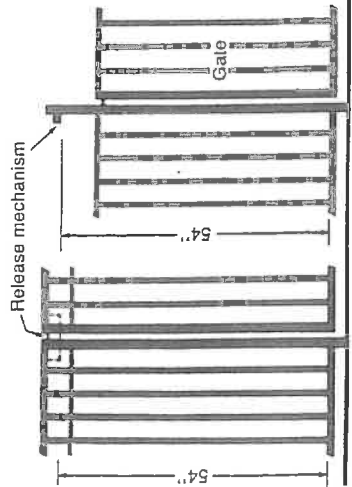
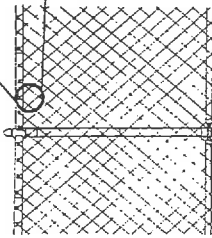

RELEASE MECHANISM LOCATED AT 54" OR HIGHER FROM THE BOTTOM OF THE GATE.

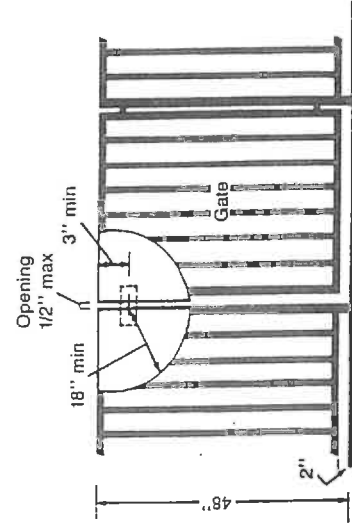

RELEASE MECHANISM LOCATED LESS THAN 54" FROM THE BOTTOM OF THE GATE.

In-Ground Pool Information

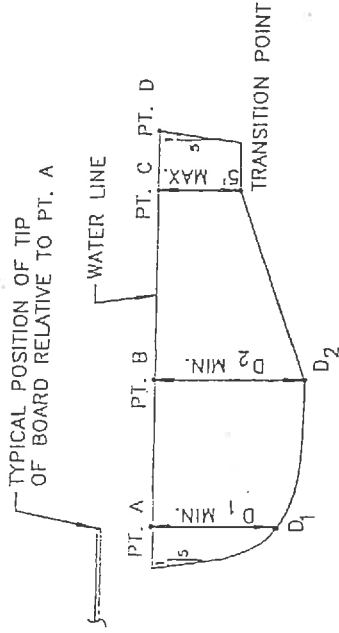

Figure 421.11

MINIMUM WATER DEPTHS AND DISTANCES BASED ON BOARD HEIGHT FOR PUBLIC AND PRIVATE POOLS

Table 421.11(1)

MINIMUM WATER DEPTHS AND DISTANCES BASED ON BOARD HEIGHT FOR PUBLIC POOLS

Board height	Minimum depth ^a at D ₁ directly under end of board	Distance ^a between D ₁ and D ₂	Minimum depth ^a at D ₂
2'2" (2/3 meter)	7'0"	8'0"	8'6"
2'6" (3/4 meter)	7'6"	9'0"	9'0"
3' meter	8'6"	10'0"	10'0"
3' meter	11'0"	10'0"	12'0"

Note a. 1 foot = 304.8 mm.

Table 421.11(2)

MINIMUM WATER DEPTHS AND DISTANCES BASED ON BOARD HEIGHT FOR PRIVATE POOLS

Board height	Minimum depth ^a at D ₁ directly under end of board	Distance ^a between D ₁ and D ₂	Minimum depth ^a at D ₂
1'8" (1/2 meter)	6'0"	7'0"	7'6"
2'2" (2/3 meter)	6'10"	7'6"	8'0"
2'6" (3/4 meter)	7'5"	8'0"	8'0"
3'4" (1 meter)	8'6"	9'0"	9'0"

Note a. 1 foot = 304.8 mm.

POOL BARRIER REQUIREMENTS

Removable pool ladder may serve as a barrier if the pool sides are a minimum of 48" above finished grade.

Features such as banks, walls, etc., that can be used for diving, shall be a minimum of 4' away from pool.

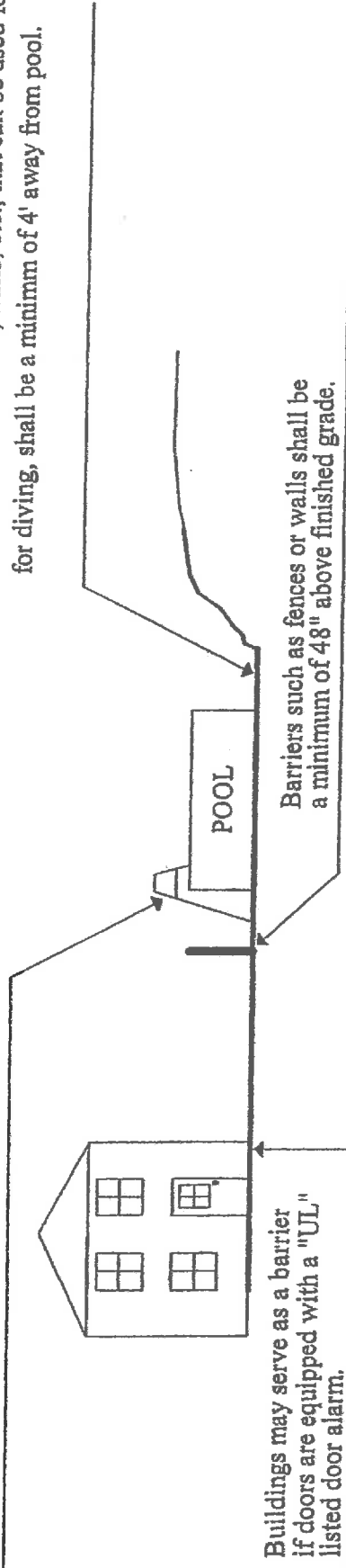

If latch is less than 54" above finished grade, latch shall be located on the inside, 3" below top, and no opening greater than 1/2" shall be located within 18" of latch.

Latch may be located on the inside or outside of the gate if is 54" minimum above finished grade

